

DC BLOCKS

SMPM, 16 kHz - 50 GHz,

SPECIFICATIONS:

Models: 8535MP

Electrical:

Frequency Range _____ 16 KHz - 50 GHz
VSWR
10 MHz - 40 GHz _____ 1.50:1 Max.
40 GHz - 50 GHz _____ 2.00:1 Max.
Insertion Loss
10 MHz - 40 GHz _____ 1.50 dB Max.
40 GHz - 50 GHz _____ 2.00 dB Max.
Impedance _____ 50 Ohms
Voltage Rating _____ 10 Volts Max.
Operating Temp. Range _____ -65°C to +125°C

Mechanical:

SMPM Connectors _____ Gold Plated Beryllium Copper
Mates with MIL-STD-348 & GPP0™ Connectors
Conductors _____ Gold Plated Beryllium Copper
Housing _____ Gold Plated Beryllium Copper

AEROFLEX
A passion for performance.

Typical Low Frequency Performance

Frequency Range	Insertion Loss	VSWR
1 kHz	24dB	-
16 kHz	3dB	6:1
50 kHz	0.5dB	2:1
110 kHz	0.1dB	1.35:1

GPP0™ is a Trademark of Corning-Gilbert, Inc.

Model Number: 8535MP

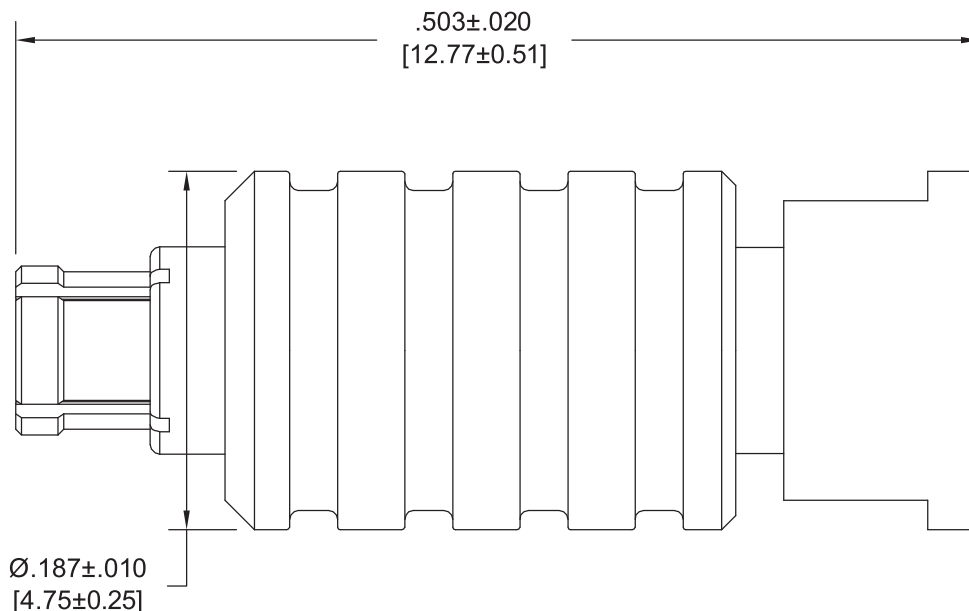

Note: Dimensions in Brackets are Expressed in Millimeters and are for Reference Only.
Design specifications are subject to change without notice.
Contact factory for technical specifications before purchasing or use.

8535MP: REV C

AEROFLEX
INMET

Aeroflex / Inmet, Inc. • 300 Dino Drive, Ann Arbor, MI 48103 • U.S.A.
888-244-6638 or 734-426-5553 • FAX: 734-426-5557
www.aeroflex.com/inmet • inmet@aeroflex.com