

Model 1419 Medium Power Coaxial Termination

dc to 18.0 GHz
10 Watts

Ruggedized SMA Connector



Features

- /// **Miniature Size and Lightweight** - All models are approximately 1.6 inches long, and weigh less than 14 grams with male connector.
- /// **Quality connector with special high temperature support beads.**

Specifications

NOMINAL IMPEDANCE: 50 Ω

FREQUENCY RANGE: dc to 18.0 GHz

MAXIMUM SWR:	
Frequency (GHz)	SWR
dc - 8	1.20
8 - 12.4	1.30
12.4 - 18	1.35

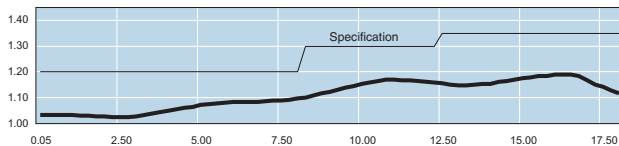

Typical M1419 SWR Performance

POWER RATING: 10 watts **average (mounted horizontally)** @ 25°C ambient temperature, derated linearly to 0 watts @ 125°C. 1 kilowatt **peak** (5 μ sec pulse width; 0.05% duty cycle).

TEMPERATURE RANGE: -55°C to +125°C

TEST DATA: SWR Testing performed across the frequency band. Test data is available at additional cost.

CONNECTOR: SMA connector per MIL-STD-348 interface dimensions - mate nondestructively with MIL-C-39012 connector. Choice of male or female connector. When ordering, prefix model number with M for male and F for female.

CONSTRUCTION: Black, finned aluminum body, stainless steel connector; gold plated beryllium copper contacts.

WEIGHT: 14 g (0.49 oz)

PHYSICAL DIMENSIONS:

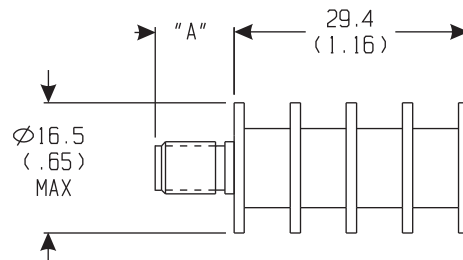

Model #	DIM A	Connector Type
M1419	11.2 (0.44)	SMA male
F1419	9.4 (0.37)	SMA female

NOTE: All dimensions are given in mm (inches) and are maximum, unless otherwise specified.