

## Model 1427 Medium Power Coaxial Termination

dc to 10.0 GHz  
25 Watts

*Convection Cooled*

**RoHS**



### Features

- /// Designed to meet environmental requirements of MIL-D-39030.
- /// Quality connector with special high temperature support beads.
- /// Low Intermodulation Option
- /// 5 Kilowatts Peak Power

### Specifications

**NOMINAL IMPEDANCE:** 50 Ω  
**FREQUENCY RANGE:** dc to 10.0 GHz

MAXIMUM SWR:	
Frequency (GHz)	SWR
dc - 4	1.10
4 - 8	1.15
8 - 10	1.30

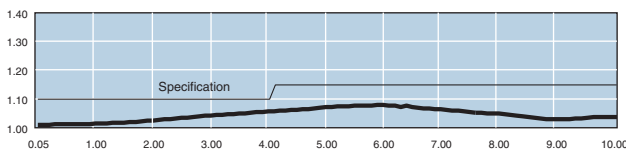

Typical M1427 SWR Performance

**POWER RATING:** 25 watts **average** (mounted horizontally) @ 25°C ambient temperature, derated linearly to 2.5 watts @ 125°C. 5 kilowatts **peak** (5 μsec pulse width; 0.25% duty cycle).

**TEMPERATURE RANGE:** -55°C to +125°C

**INTERMODULATION (Model 1427-X-LIM Only):** IM3 (Reflected) = -100 dBc with two input signals @ 869 MHz and 891 MHz with an average power of +41 dBm each.

**TEST DATA:** SWR Testing performed across the frequency band. Test data is available at additional cost.

**CONNECTOR:** Type N or 2.92mm connectors mate nondestructively with MIL-C-39012 connector.

Connector Options	Type/Description
1	2.92mm, Female
2	2.92mm, Male
3	Type N, Female
4	Type N, Male

**CONSTRUCTION:** Black, finned aluminum body, stainless steel connector; gold plated beryllium copper contacts.

**WEIGHT:** 150 g (5.2 oz)

**PHYSICAL DIMENSIONS:**

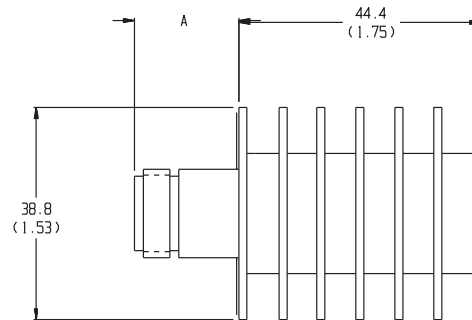

Model #	DIM A	Connector Type
1427-1	12.7 (0.50)	2.92mm female
1427-2	14.0 (0.55)	2.92mm male
1427-3	15.0 (0.59)	N female
1427-4	22.9 (0.90)	N male

**NOTE:**

1. All dimensions are given in mm (inches) and are maximum, unless otherwise specified.
2. Unit available with RoHS compliant materials, specify when ordering.

**MODEL NUMBER DESCRIPTION:**

**Example:**

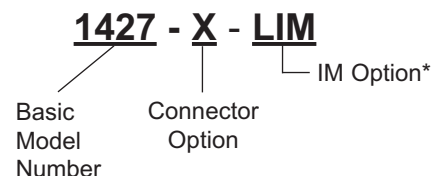

\* Add -LIM to entire model number for Low Intermodulation option. Option not available through Express.